



WILD FORAGED SEASONAL PRODUCE

26, EAST BAY LANE, HERE EAST, LONDON, E15 2GW

discover

“A restaurant promising a fish and meat-focused menu, with wild and foraged ingredients”. Time out

...OUR STORY

WILD MEATS, LINE CAUGHT FISH, THE WILD FORAGED SEASONAL PRODUCE, SMALL ETHICAL PRODUCERS, PEOPLE THAT CARE.

SHANE IS A PASSIONATE NEW ZEALANDER WHO LOVES BEING A CHEF, PASSIONATE ABOUT THE ENVIRONMENT AND BELIEVES THAT HONESTY AND INTEGRITY ALWAYS WIN THE DAY.

“WE AIM TO COMBINE PRECISE TECHNIQUE AND PRODUCT KNOWLEDGE OF FORMAL DINING WITH A PERSONAL TOUCH THAT IS UNIQUELY SHANES. KIWIS GROW UP RESPECTING THE ENVIRONMENT OUR RESTAURANTS NOT ONLY RESPECT THE ENVIRONMENT BUT ALLOW THE ENVIRONMENT TO LET US KNOW WHAT TO DO. PEOPLE MATTER SO ALL MEMBERS OF SHANES ARE FAMILY”



discover

...OUR RESTAURANT

WILD MEATS, LINE CAUGHT FISH, THE WILD FORAGED SEASONAL PRODUCE, SMALL ETHICAL PRODUCERS, PEOPLE THAT CARE.

SHANE'S IS A CONTEMPORARY, FINE DINING RESTAURANT WITH A CASUAL ATMOSPHERE. ONE THAT SHOWCASES SEASONAL BRITAIN, THE DIVERSITY OF ETHICAL PRODUCE WITH FRESHNESS AND QUALITY LEADING THE WAY. AS THE SEASONS COME AND GO OUR MENU CHANGES WITH THE COLOURS AND FLAVOURS OF THE ENVIRONMENT. FIELD TO PLATE ITS THAT SIMPLE



discover

...OUR VENUE

“AS THE SEASONS COME AND GO OUR MENU CHANGES WITH THE COLOURS AND FLAVOURS OF THE ENVIRONMENT. CASUAL ATMOSPHERE WHERE NOTHING IS A PROBLEM AND YOU ARE MADE TO FEEL AT HOME”.



COCKTAILS
FOOD
LIVE MUSIC
EVENTS
OPEN SEVEN DAYS A WEEK





CAPACITY: 200 SEATED/STANDING
 70 SEATED (INDOORS)
 100 (INDOOR & OUTDOORS)
 SOUNDSYSTEM: SONOS

SPECIFICATION

INDOOR AND OUTDOOR AREAS

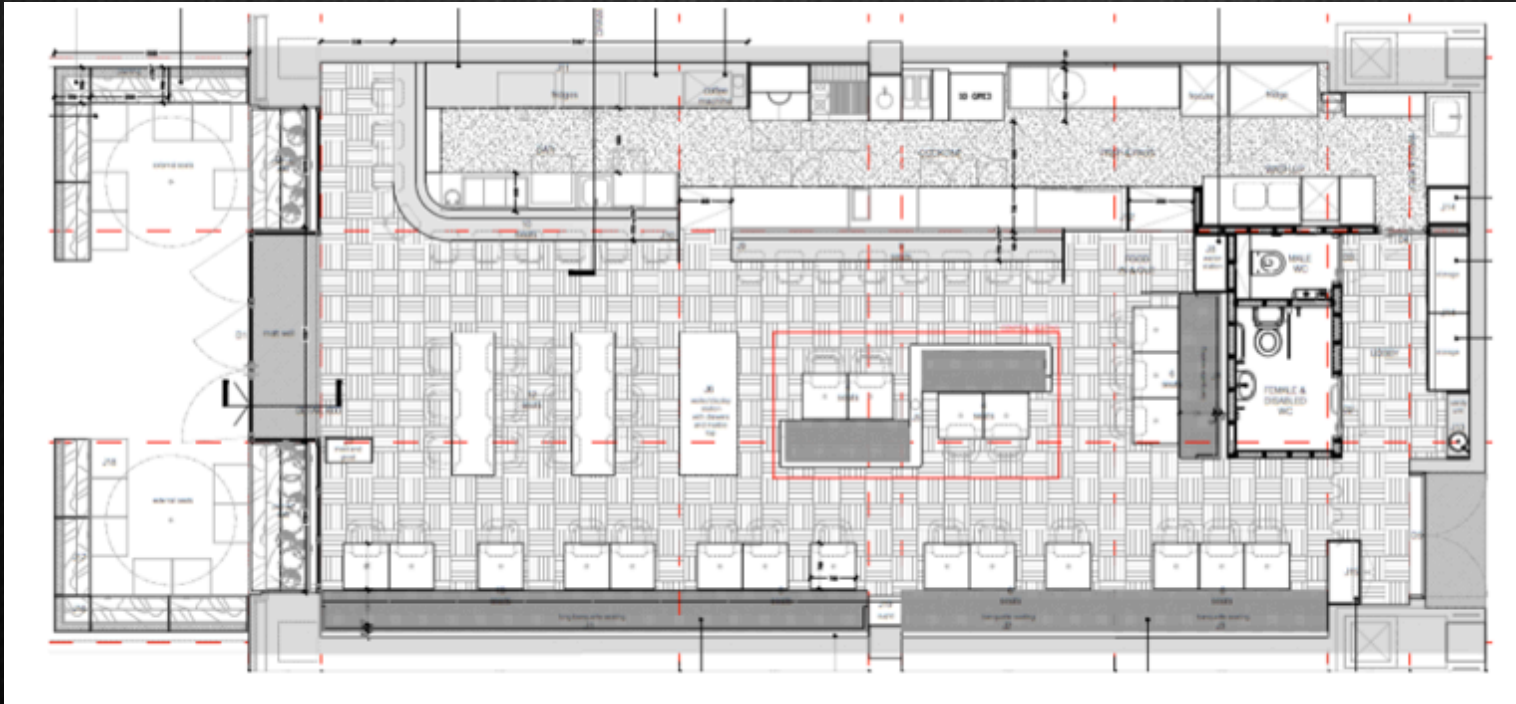



PRIVATE HIRES

FOR MORE INFORMATION ABOUT OUR AVAILABILITY
PLEASE EMAIL:
contact@shanesoncanalside.com

HIRE FEE

MONDAY – SUNDAY: £500

MINIMUM SPEND:

SUNDAY & MONDAY: £2,000

TUESDAY & WEDNESDAY: £3,000

THURSDAY: £4,000

FRIDAY & SATURDAY: £5,000

FOR CORPORATE AND BUSINESS RATES, PLEASE EMAIL DIRECTLY.

*MINIMUM SPEND IS SUBJECT TO 12.5% SERVICE CHARGE WHICH
GOES DIRECTLY TO OUR STAFF



discover

LOCATION

SHANE'S ON CANALSIDE IS LOCATED ALONG PICTURESQUE REGENT'S CANAL, IN HERE EAST, STRATFORD. IT CAN BE EASILY ACCESSED FROM HACKNEY WICK OVERGROUND STATION OR HERE EAST SHUTTLEBUS FROM STRATORD STATION.

OPENING HOURS:

SUNDAY - TUESDAY: 11AM – 11PM

WEDNESDAY: 11AM – 11.30PM

THURSDAY – SATURDAY: 11AM – MIDNIGHT

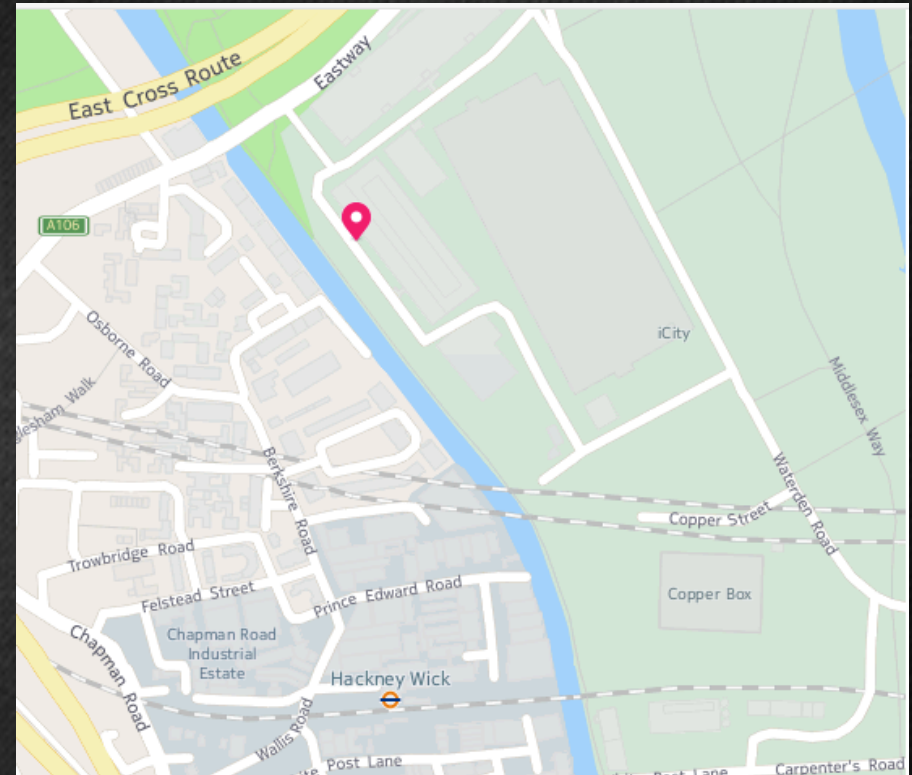

26, EAST BAY LANE, HERE EAST, LONDON, E15 2GW

www.shanesoncanalside.com

0203 828 9991

